



## V-Track Installation Instructions

First thank you for the confidence in purchasing the V-track stabilizer. This is a quality product that's designed for ease of installation and years of trouble free operation. Please follow the detailed installation procedures below.

### Step1:

Bring together the boot plate, Qty 2 - 2 inch by  $\frac{1}{4}$  inch thick round washer, Qty 2 - 1.5 inch by  $\frac{1}{8}$  inch washer and Qty 2 -  $\frac{3}{8}$  inch by  $1\frac{1}{4}$  inch long bolts and lock nut together (see Figure A).

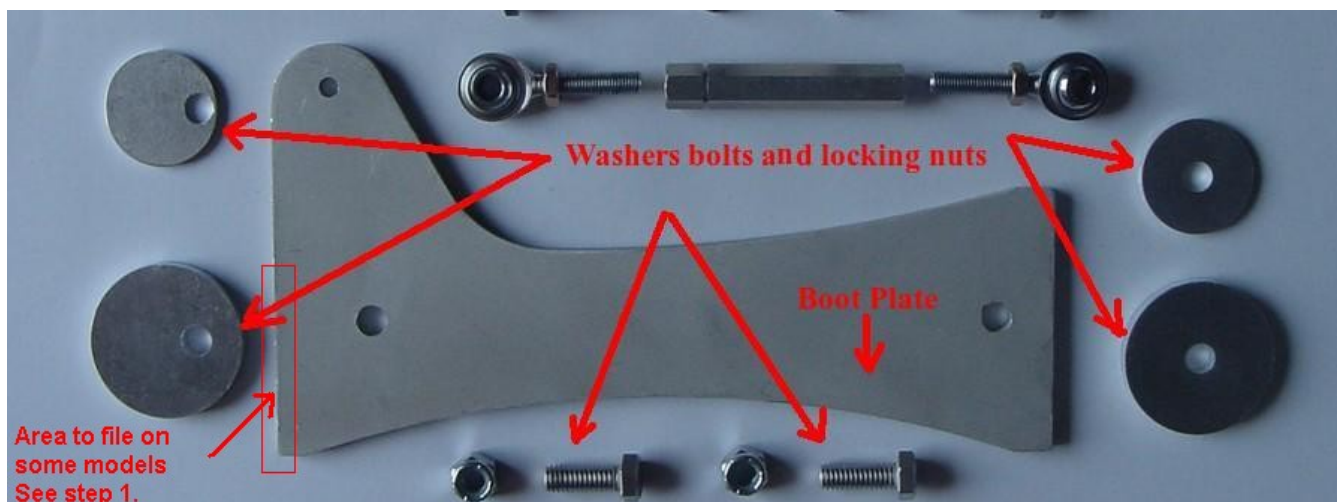


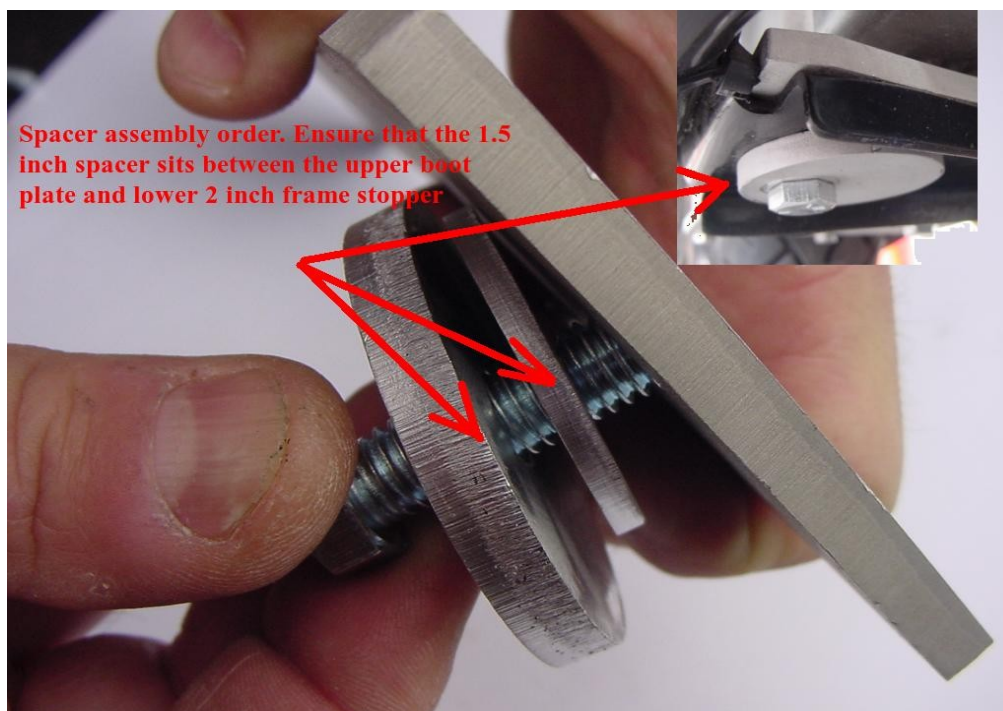
Figure A

Install boot plate above frame cross member in front of the oil pan as shown in the Figure B. Assemble the washers as shown in Figure C with the 1.5 inch washer sandwiched between the boot plate and two inch washer. The 1.5 inch washer will fit inside the existing two 1.5 inch holes in the frame cross member. Ensure that the washers with the offset holes are installed on the right hand side of the frame cross member.

**Note:** On some models, you may need to file the boot plate on the side of the kick stand to allow the bolt and washers to proper align. The frame weld may interfere with the boot plate on some models.

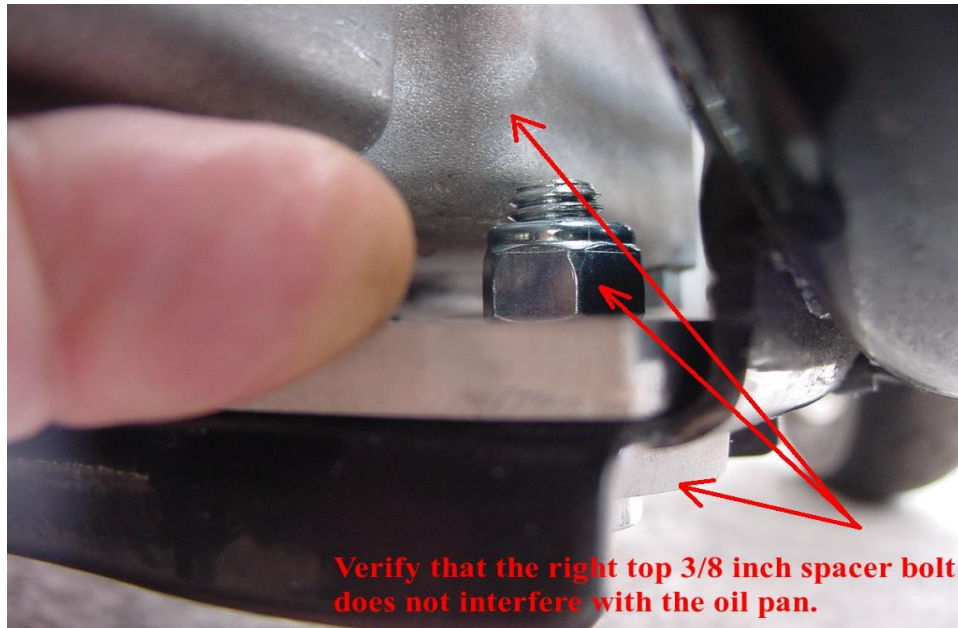


**Figure B**



**Figure C**

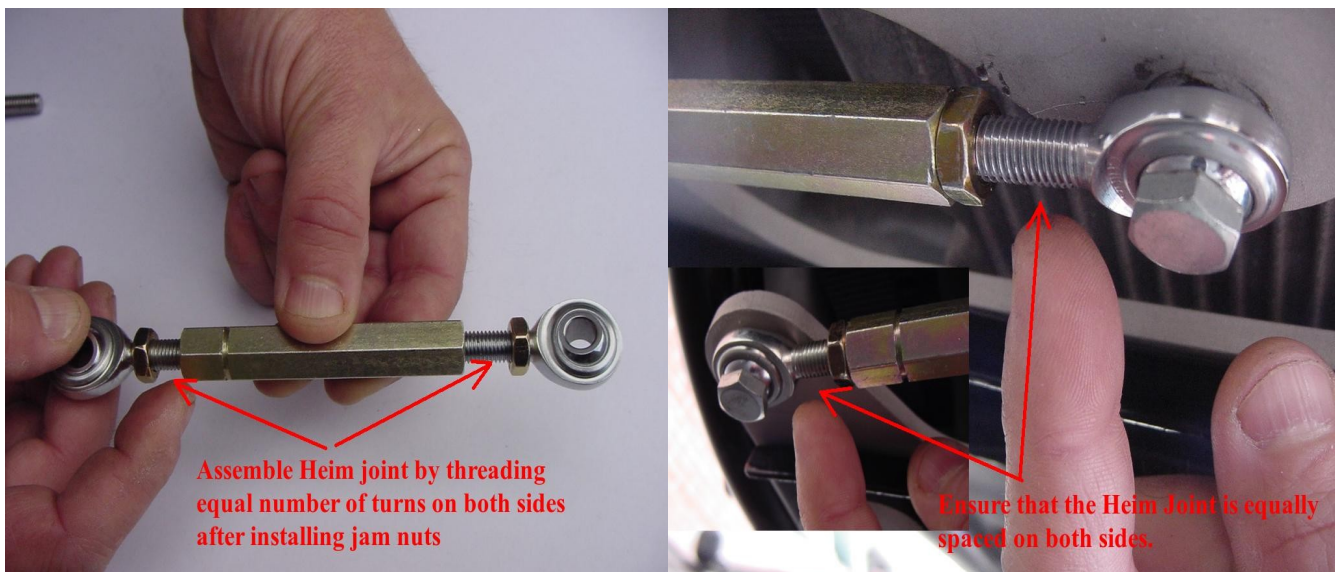
Thread the 3/8 inch bolts through the bottom of the two inch washer and install the locking nut above the boot plate. Tighten to 25 – 30 Ft/Lbs . See figure D below.



**Figure D**

## **Step2:**

Assemble the Hiem joint as illustrated in Figure F. Thread the lock nuts (Left and and Right hand threads) onto each Heim joint and thread the Heim joint into the 3 inch turn buckle. Ensure that the the Heim joints are threaded in equal number of turns at each end. ( about 50 % threaded in).

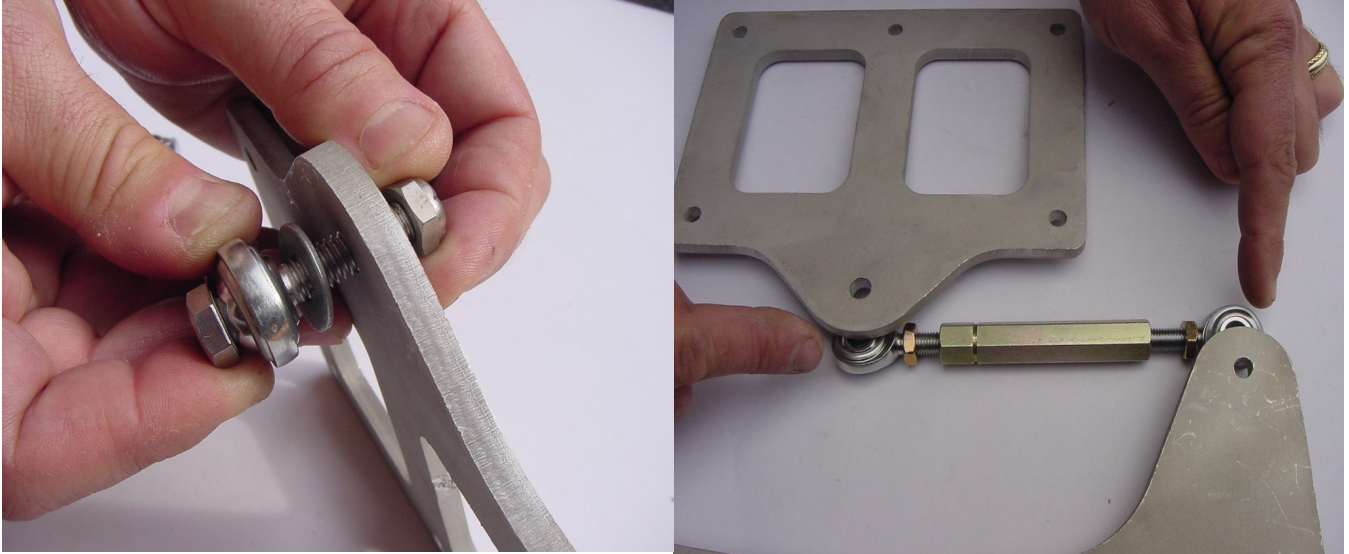


**Figure F**



### **Step3:**

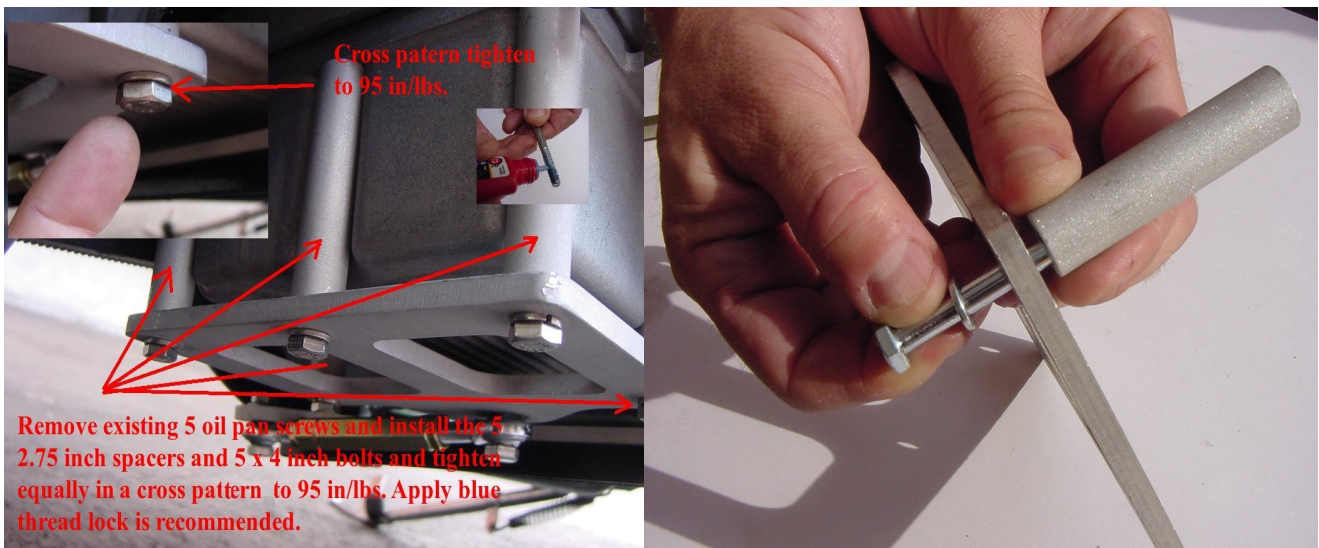
Install one end of the Heim joint into the lower stabilizer oil pan adapter plate as shown in Figure G. Install the 5/16 inch by 1 1/8 inch long bolt into one end of the Heim joint followed by the 5/16 inch washer. Then install the bolt into the plate and secure with the 5/16 inch self locking bolt. Tighten to 15 Ft/Lb



**Figure G**

### **Step4:**

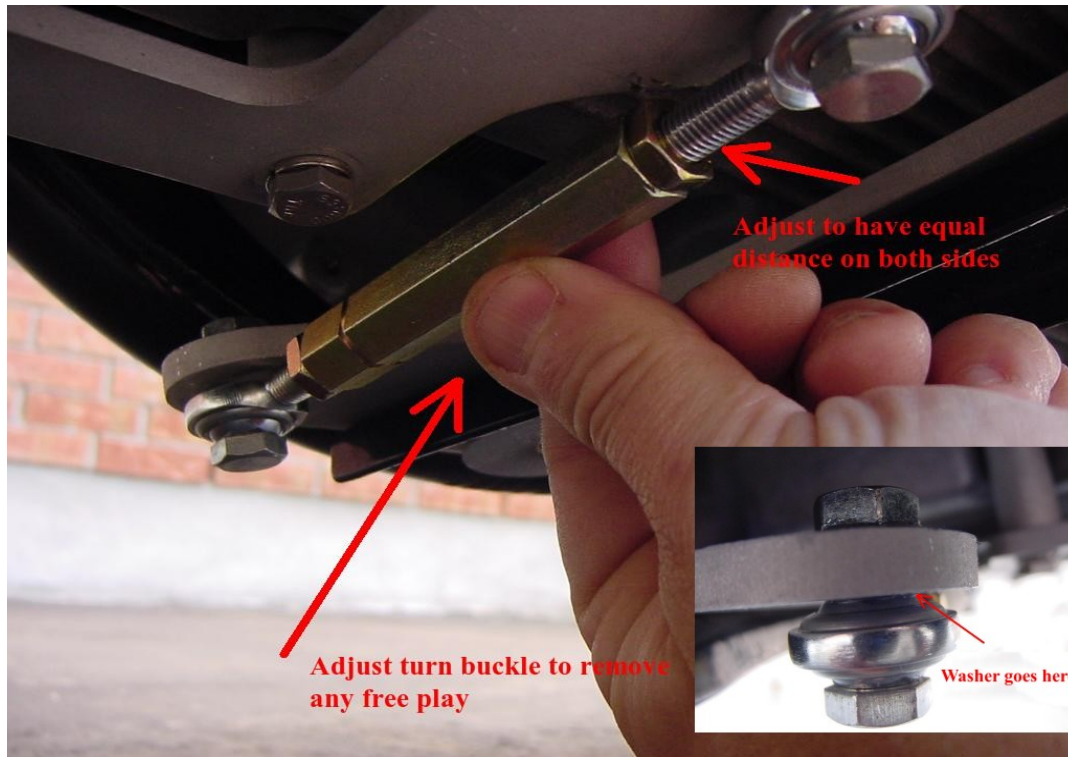
Now remove the 5 rear bolts on the oil pan. Install the Qty 5 1/4 inch by 4 inch bolts with the supplied 2 3/4 inch spacers through the lower plate assembly. See Figure H. Apply a small amount of blue thread lock as shown in the figure below. Tighten in a cross pattern to no more than 95 In/Lbs or 8 Ft/Lbs. **Any more and you risk damaging the threads in the upper transmission case.**



**Figure H.**

## **Step5:**

Install the other end of the Heim joint into the end of the boot plate using the supplied 5/16 inch by 1 1/8 inch bolt and install the washer between the boot plate and Heim joint as shown in Figure I. Turn the turn buckle while holding the end of the Heim joint to adjust the length until the bolt enters the boot plate hole easily. Tighten to 15 Ft/Lbs. Turn the turn buckle to remove any free play using your fingers only. **DO NOT USE A WRENCH.** Then using two wrenches, lock down each jam nut at either end. Once tight, you should still be able to twist the Heim joint with your fingers from left to right with some resistance.



**Figure I**

## **Completed:**

Below is the final image showing the V-track installed on your motorcycle. Enjoy your purchase and as always. **RIDE SAFE.**

**Disclaimer: Use this touring stabilizer at your own risk, Parts4PowerToys is not liable, or responsible in any way for any damage, or injury to you, and your passenger, or your motorcycle from installation of this device.**



